

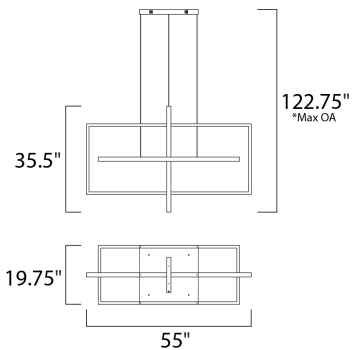

PRODUCT DESCRIPTION

Large scale rectangles of Brushed Champagne are positioned on different planes that intersect creating a novel lighting experience. Double rows of LED provide more than ample illumination adding to the value of this original design.



*max overall height

MEASUREMENTS

DIMENSION : 55" L x 19.75" W x 35.5" H
 MAX OAH : 122.75" OAH
 HANGING WEIGHT : 35.2 lb

LAMPING

INPUT VOLTAGE : 120V
 LUMENS : 6,000 Rated (2,500 Del.)
 BULB : 3 x 123W LED PCB Integrated , 123W Total
 BULB INCLUDED : (Integrated)
 DIMMABLE : Triac CL
 CRI : 90+ CRI
 COLOR_TEMP : 3000K

FINISHES OPTION

 Brushed Champagne (BCN)

MATERIAL

Stainless Steel

RATINGS

cETLus
 Dry Location



ADDITIONAL

ADJUSTABLE
 RATED LIFE 25000 Hours
 OPERATING TEMPERATURE:
 -20°C (-4°F), 40°C (104°F)

Always consult a qualified electrician before installing any lighting product.



Contemporary
 Lighting™

WESTERN DISTRIBUTION CENTER (HEADQUARTER)
 253 NORTH VINELAND AVE | CITY OF INDUSTRY, CA 91746

EASTERN DISTRIBUTION CENTER
 101 GARDNER PARK | PEACHTREE CITY, GA 30269

P. 626.956.4200 | F. 626.956.4225 | maximlighting.com