

PRODUCT DESCRIPTION

White tubing is playfully bent into an interesting Mobius loop. Inside the tube is a round LED board which directs the light in all directions as if the source was neon.

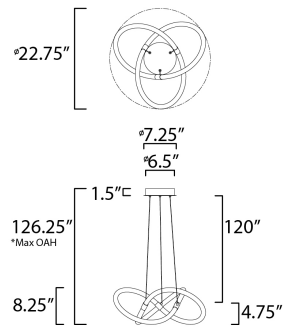

*max overall height

MEASUREMENTS

- DIMENSION : 22.75" L x 22.75" W x 8.25" H
- MAX OAH : 126.25" OAH
- CANOPY : 7.25" W x 1.5" H x 7.25" L
- HANGING WEIGHT : 5.302 lb

LAMPING

- INPUT VOLTAGE : 120V
- LUMENS : 4,000 Rated (3,010 Del.)
- BULB : 43W LED PCB Integrated , 43W Total
- BULB INCLUDED : (Integrated)
- DIMMABLE : ELV or Triac CL
- CRI : 90 CRI
- COLOR_TEMP : 3500K

FINISHES OPTION

-  Polished Chrome (PC)

GLASS

White 01

MATERIAL

Steel, PMMA Acrylic

RATINGS

cETLus
Dry Location



ADDITIONAL

SLOPE: 30
RATED LIFE 20000 Hours
OPERATING TEMPERATURE:
-20°C (-4°F), 40°C (104°F)

Always consult a qualified electrician before installing any lighting product.



WESTERN DISTRIBUTION CENTER (HEADQUARTER)
253 NORTH VINELAND AVE | CITY OF INDUSTRY, CA 91746

EASTERN DISTRIBUTION CENTER
101 GARDNER PARK | PEACHTREE CITY, GA 30269

P. 626.956.4200 | F. 626.956.4225 | maximlighting.com