



**PRODUCT DESCRIPTION**

An artistic and flexible design concept, crystal orbs are illuminated behind curved Naturally Aged Brass shades. The oversized panes are mounted to LED light housings that can rotate to provide either ambient indirect lighting that is directed upwards at the crystal for a glowing effect, or these LEDs can be rotated to shine downward for ample lighting. The two-arm wall sconce has a longer extension in the arm with individual light switches on the backplate to be used for directed task lighting great for bedside applications or creating a space within a room that will serve as task lighting.

**MEASUREMENTS**

DIMENSION : 11.75" W x 11.75" H x 26.5" Ext  
 MAX OAH : 4.75" W x 11.75" H  
 HANGING WEIGHT : 5.5 lb

**LAMPING**

INPUT VOLTAGE : 120V  
 LUMENS : 1,000 Rated (650 Del.)  
 BULB : 2 x 5W LED AC Integrated , 10W Total  
 BULB INCLUDED : (Integrated)  
 DIMMABLE : Triac or ELV  
 CRI : 90 CRI  
 COLOR\_TEMP : 3000K  
 LIGHTING\_DIRECTION : Directional

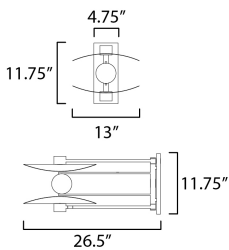

**FINISHES OPTION**

 Black / Natural Aged Brass (BKNAB)

**MATERIAL**

Steel, Aluminum, Crystal

**RATINGS**

cETLus  
 Damp Location



**ADDITIONAL**

INSTALL UP/DOWN: Up/Down  
 RATED LIFE 35000 Hours  
 OPERATING TEMPERATURE:  
 -20°C (-4°F), 40°C (104°F)

Always consult a qualified electrician before installing any lighting product.



WESTERN DISTRIBUTION CENTER (HEADQUARTER)  
 253 NORTH VINELAND AVE | CITY OF INDUSTRY, CA 91746  
 EASTERN DISTRIBUTION CENTER  
 101 GARDNER PARK | PEACHTREE CITY, GA 30269  
 P. 626.956.4200 | F. 626.956.4225 | maximlighting.com