

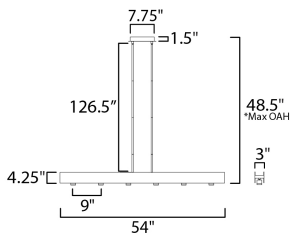

**PRODUCT DESCRIPTION**

Extruded aluminum girders of Black encase a series of adjustable LED spots accented with Polished Chrome. The lights can be directed to the surface below with high powered functional light. Available in 44" and 54" lengths these pendants work equally well over kitchen islands or rectangular tables.



\*max overall height

**MEASUREMENTS**

- DIMENSION : 54" L x 3" W x 4.5" H
- MAX OAH : 54" OAH
- CANOPY : 4.75" W x 1.5" H x 7.75" L
- HANGING WEIGHT : 12.54 lb

**LAMPING**

- INPUT VOLTAGE : 120V
- LUMENS : 1,440 Rated (1,000 Del.)
- BULB : 6 x 3W LED PCB Integrated , 18W Total
- BULB INCLUDED : (Integrated)
- DIMMABLE : Triac CL or ELV
- CRI : 80+ CRI
- COLOR\_TEMP : 3000K

**FINISHES OPTION**

- Black / Polished Chrome (BKPC)

**MATERIAL**

Aluminum

**RATINGS**

cETLus  
Dry Location



**ADDITIONAL**

ADJUSTABLE  
SLOPE: 30  
RATED LIFE 50000 Hours  
OPERATING TEMPERATURE:  
-20°C (-4°F), 40°C (104°F)

Always consult a qualified electrician before installing any lighting product.



WESTERN DISTRIBUTION CENTER (HEADQUARTER)  
253 NORTH VINELAND AVE | CITY OF INDUSTRY, CA 91746  
EASTERN DISTRIBUTION CENTER  
101 GARDNER PARK | PEACHTREE CITY, GA 30269  
P. 626.956.4200 | F. 626.956.4225 | maximlighting.com